

## INSTRUCTION MANUAL FOR SAW/FILES

### Operation Procedures

1. Connect the coupler to the air inlet ① (SI-4730) or swivel regulator ③ (SI-4740)

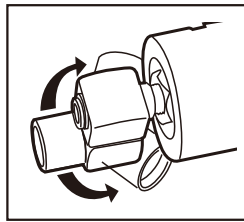

2. Pour approx. 0.5cc (2 to 3 drops) of the oil through the coupler. Connect it to the air hose, and run for 3 to 5 seconds to circulate the oil.

3. Prior to connect the air hose thereto, be sure to mount a blade or a file. Loosen the set screw ② with Allen wrench. For the saw blade, insert it in the longitudinal cuts, and for the file, do it pursuant to the hole in the depth.

### SI-4730

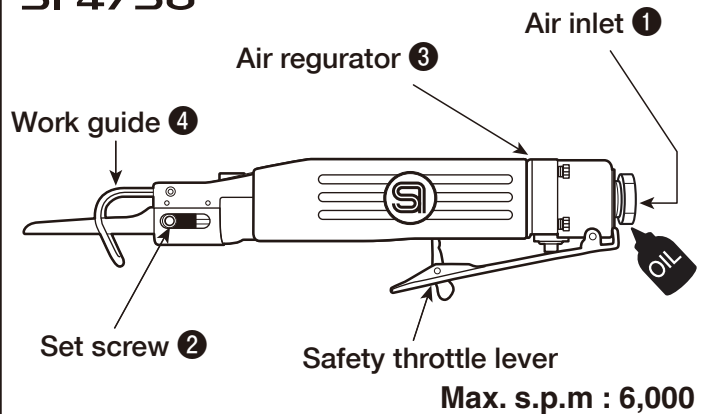

**Accessories :** Saw blade 32T (1)  
2mm Allen wrench (1)  
3mm Allen wrench (1)  
Blade screw (1)  
Set screw (2)  
Safety instruction (1)

#### SI-4730

Fit the chuck hole to the blade hole, and penetrate and tighten it with blade screw. Furthermore, fix it with the another set screw on both sides.

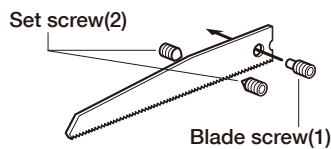

#### SI-4740

Pinch the blade with 4 pieces of set screw at the chuck holes on both sides.

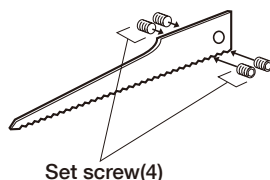

#### SI-4730/SI-4740

##### Option File attached

Pinch the file blade shaft with 4 pieces of set screw at the chuck holes on both sides.

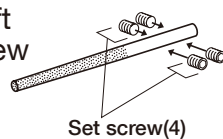

### SI-4740

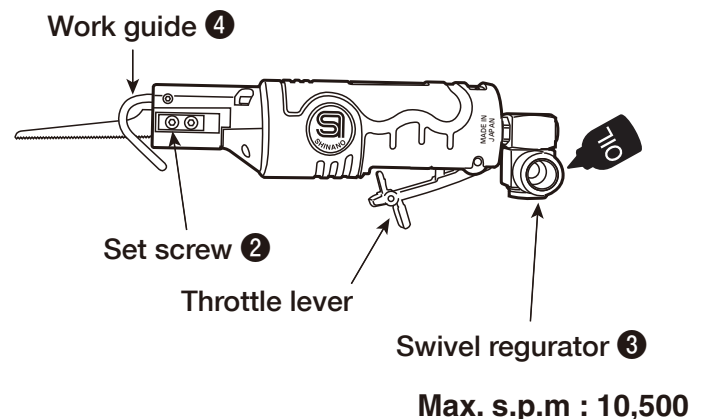

**Accessories :** Saw blade 32T (1)  
2mm Allen wrench (1)  
2.5mm Allen wrench (1)  
Set screw (4)  
Safety instruction (1)

4. Be sure to adjust the speed with the air regulator ③

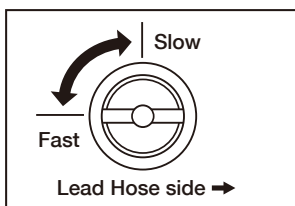

#### SI-4730

Insert a minus driver in the groove, and adjust it to clockwise(right)-"Low speed" or counter clockwise(left)-"High speed"

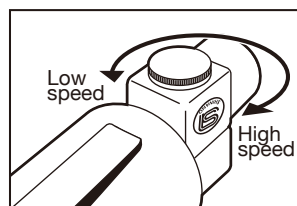

#### SI-4740

Adjust regulator dial to clockwise(right)-"High speed" or counter clockwise(left)-"Low speed"

5. The work guide ④ length can be adjusted. For adjustment of length, loosen the set screw with the 2mm Allen wrench. In addition, when a file is attached thereto, it is convenient to remove the work guide.

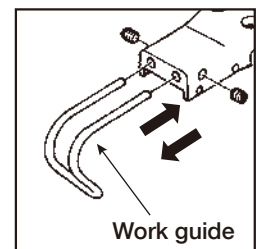

6. Press the stopper to the direction as indicated by arrow, and the lock is released. when freed, it is locked.

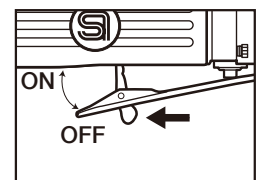

## SI-4730 / SI-4740

Model Number	File Shank Opening mm/(in)	Cutting cap mm/(in)	Stroke length mm	Free Speed s.p.m	Out Put W	Weight kg/(lb)	Noise Level dBA/(power)	Vibration m/s <sup>2</sup>	Avg Air Consumption CFM	Air Inlet Size in	Hose Size mm/(in)
<b>SI-4730</b>	5/(3/16)	5/(3/16)	9	6.000	296	0.92(2.03)	86/(97)	15.1/1.9	3.0	1/4	10/(3/8)
<b>SI-4740</b>	5/(3/16)	4/(3/32)	5	10.500	135	0.52(1.15)	83/(94)	14.5/1.9	1.7	1/4	10/(3/8)

Noise levels according to ISO 15744:2008,ISO 11203:2009      Vibration level according to ISO 28927:12

## WARNING

- Be sure to remove the air hose for replacement of the saw blade and file.
- Be sure to firmly and securely install the saw blade and file.
- Never use for the machine the other saw blade and file than the products presented or recommended by us.
- Be sure to remove the Allen wrench used for replacement of the saw blade and file.
- Vibration will occur to some extent. Avoid continuous operation if possible, and take a break of approx. 10 minutes per an hour.

## CAUTION

- The air tool is a precious tool. Neither throw nor drop the tool, nor give a strong shock thereto. Such actions will result in failure.
- Avoid the long time idling run or unnecessary idling operation, which will encourage to wear. This may result in trouble.
- Operate the tool within the air pressure of 0.63Mpa (6.5kg/cm<sup>2</sup>). If operated in high pressure, the maximum allowance speed will be exceeded, which may result in damage of components.
- Avoid using it for the other purpose than the usage, and avoid the forcible operation beyond the capability.
- After using the tool, be sure to prevent dusts from entering at the air inlet.

 **SHINANO INC.**

<http://www.shinanoinc.com>

MADE IN JAPAN